



# ULTRA EFFICIENT ULTRA DECK FLAT ROOF BOARD



## Performance Insulation

**Ultra Deck flat roofboard is a high performance laminated board that provides both insulation and plywood decking for flat and low pitch timber joist roofs.**

The board size is 1200mm x 2400mm and consists of an external grade 6mm plywood decking board factory bonded to rigid foil-backed polyisocyanurate (PIR) insulation. Easily handled and installed, it offers a practical and cost effective solution for both new build and refurbishment projects.

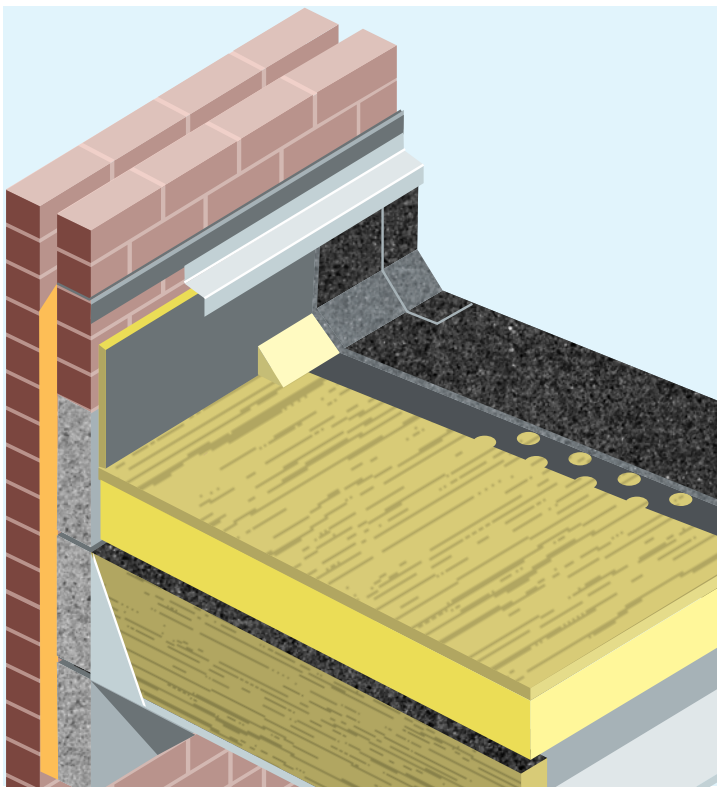

## Benefits of using Ultra Deck

- High performance rigid insulation - excellent thermal performance.
- Insulation, structural decking and vapour control layer are combined in one board and one fixing operation.
- Buildings are quickly watertight.
- Suitable for use beneath most bitumen based and single ply waterproofing systems.

## U Values

Illustrated below are the U values achieved by Ultra Deck fixed to timber joists with a plasterboard ceiling on the underside.

U Value W/m2k	0.25	0.22	0.20	0.18	0.17	0.16	0.14
Ultra Deck Size	81mm	96mm	106mm	116mm	126mm	131mm	156mm

## Environmentally Friendly

Using the Ultra Deck roof board in complying with building regulations makes a substantial impact on reduction of CO2 emissions from buildings. The insulation material used has the following additional benefits for the environmentally conscious user.

- Zero ozone depletion potential (ODP).
- Zero global warming potential (GWP) of less than five.
- Environmental impact rating (BRE Green Guide) of A.

## Easy Installation

- Ultra Deck should be fixed to minimum 50mm wide joists set at maximum 600mm centres.
- Roofs having regular foot traffic - joists set at 400mm centres.
- Boards should be staggered and butt jointed with a 2mm gap.
- Board edges should be a minimum of 20mm over the edge of the supporting timber.
- Timber noggins minimum 50 x 50mm should be fitted to support the board edges.
- To maintain a continuous vapour control layer, mastic should be laid on top of the joists and noggins and be wide enough to cover the joints of the two butted edges of the board.
- Fixings should be used at 200mm centres around the edge of the board and at 300mm centres through the middle of the board.
- Fixings should be a low profile screw type and be long enough to penetrate 35mm into the supporting timber.

## Cutting and Storage

- Ultra Deck roof boards can be cut using a fine toothed hand or power saw. The boards should be stored off the ground and must be covered to ensure they are protected from the elements.

## Contact Us

Tyne Insulation Supplies Ltd  
Orion Way  
Orion Business Park  
North Shields  
Tyne & Wear NE29 7SN

Tel: 0191-257-8640  
Fax: 0191-257-8413  
[www.tyneinsulation.co.uk](http://www.tyneinsulation.co.uk)

Tyne Insulation Supplies Ltd  
Unit 47, Oakhill Trading Estate  
Devonshire Road  
Walkden  
Manchester M28 3PT

Tel: 01204-704622  
Fax: 01204-707222  
[www.tyneinsulation.co.uk](http://www.tyneinsulation.co.uk)

**For more details call 0191 257 8640  
or visit [www.tyneinsulation.co.uk](http://www.tyneinsulation.co.uk)**



ULTRA™ IS PART  
OF THE TYNE  
INSULATION  
GROUP

